



# WATERLILY BOATS

TECHNICAL SPECIFICATIONS

## GENERAL LAYOUT . WATERLILY MINI

CABIN | LIVING ROOM | BATHROOM

78 723€

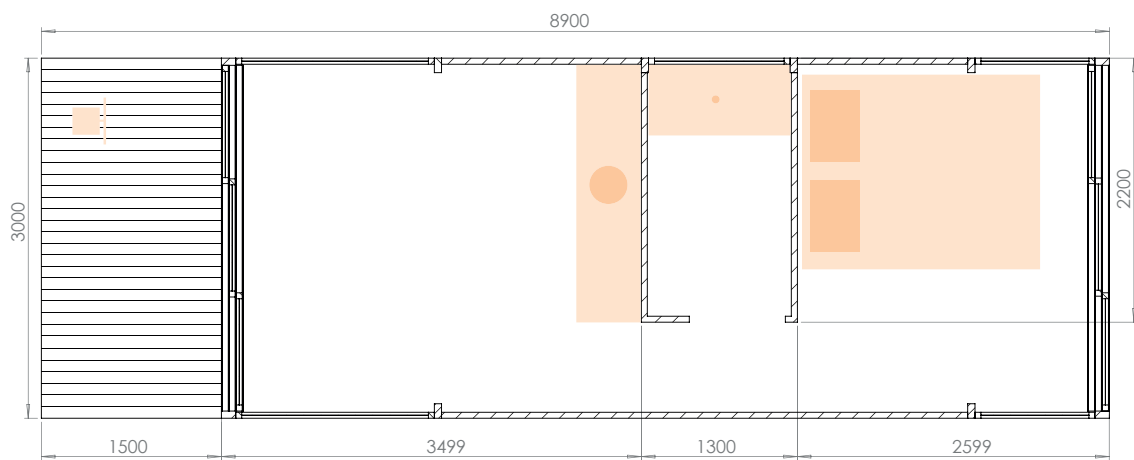

MODEL YEAR 2022 PRICES.

We reserve the right to modify the specifications of our models without prior notice.  
**PRICE NOT INCLUDING:** VAT or taxes, shipping & handling, insurance, handover and launching



## EQUIPMENT

### ESSENCIAL EQUIPMENT 14 655€

FLAG POLE	
SAFETY RAIL	
140ah SERVICE BATTERY	
100L BLACK AND CLEAN WATER TANKS	
GENERAL EARTH CONNECTED 220v SYSTEM	
GENERAL LED LIGHTNING	
12v SAFETY SYSTEM, BILGE PUMPS, HONK	
12v BATTERY CHARGER	
VINYL PLANK FLOORING (WATER RESISTANT)	
BASIC KITCHEN FURNITURE*	
DINING ROOM EQUIPMENT (DINING TABLE AND CHAIRS FOR 4)	
LIVING ROOM FURNITURE (SOFA BED, CENTER TABLE AND RUG)	
BATHROOM EQUIPMENT (WASHSTAND, SHOWER, TOILET AND MIRROR)	
PORT AND STARBOARD HULL ACCESS	
PREMIUM KITCHEN (INCLUDES ISLAND WHEN POSSIBLE)*	1 050€
PREMIUM DINING AND LIVING ROOM	1 190€
DECOR ITEMS (LIVING ROOM: ARMCHAIR, LAMP, CUSHIONS AND A PLANT; BEDROOM: MIRROR, QUILT COVER, LAMP AND RUG; BATHROOM: 3 PIECE BATH SET, ROLL HOLDER, WASTE BIN, TOILET BRUSH, BASKETS AND TOWEL HOLDER)	972€

\*HOME APPLIANCES NOT INCLUDED

### COMFORT EQUIPMENT (INCLUDES ESSENCIAL EQUIPMENT) 21 767€

BLACK WATER MACERATOR PUMP	
HYDRAULIC STEERING	
HELM CONSOLE IN THE BOW	
CONNECTIVITY PACK WITH IPAD CHARGER IN THE HELM CONSOLE	
CLEAN WATER CONNECTION DIRECT FROM EARTH	

### MOTORIZATIONS AND BATTERIES

2x TORQEEDO CRUISE RL 4.0	8 271€
2x TORQEEDO CRUISE 12.0 RXL TORQLINK	21 408€
2x YAMAHA PETROL ENGINE 25hp F25	15 776€

### BATTERY PACKS

4x AGM 12v 160ah appr. 7kWh	1 624€
8x AGM 12v 160ah appr. 15kWh	3 248€
PYLONTECH LITHIUM 7kWh	3 901€
PYLONTECH LITHIUM 15kWh	7 557€

### ELECTRIC CIRCUIT

PACK USB SOCKETS	303€
SOLAR PANELS ON ROOFTOP 340w EACH (1-8 MAX.)	789€
INVERTER 12/220v - 2000 VA	1 392€
INVERTER 48/220v - 2000 VA	1 508€
INVERTER 48/220v - 5000 VA	2 088€
2.2 HONDA GENERATOR	1 684€

### WATER CIRCUIT

EXTRA 100L CLEAN WATER TANK	267€
EXTRA BLACK WATER TANK	284€

## HI-FI, VIDEO & ELECTRONIC

### HI-FI & VIDEO

PREMIUM AUDIO	1 740€
---------------	--------

### ELECTRONIC

2nd H50 HANDSET AT HELM CONSOLE FOR VHF B&G	322€
B&G VHF V50	909€
AIS 500 B&G TRANSCEIVER WITH ANTENNA COUPLING	1 339€
B&G ZEUS3 12" DISPLAY AT HELM CONSOLE	3 039€
B&G 4G RADAR	2 631€
B&G AUTOPILOT	4 060€

## COATINGS AND UPHOLSTERY

### EXTERIOR COATINGS

WAVE CORK	1 392€
PLAIN CORK	835€
COMPOSITE PANEL	1 392€

### EXTRA

TEAK TABLE FOR 6 PERSONS, CHAIRS AND SUNSHADE	1 561€
EXTERIOR PUFF	219€
SUN LOUNGER WITH CUSHIONS	273€

## SOLAR PROTECTION

### EXTERIOR SHADING

SUN SHADE 3x2m	128€
----------------	------

### BLACKOUT

BLACKOUT SYSTEM FOR BEDROOM	1 392€
BLACKOUT SYSTEM FOR LIVING ROOM	1 392€

### CURTAINS

CURTAINS FOR BEDROOM	1 624€
CURTAINS FOR LIVING ROOM	1 624€
CURTAINS BLACKOUT FOR BEDROOM	2 088€
CURTAINS BLACKOUT FOR LIVING ROOM	2 088€

### ROOFTOP SHADING

STAINLESS STEEL RIGID T-TOP WITH 8 SOLAR PANELS	9 744€
WIND PROTECTION FOR T-TOP	1 032€

## INTERIOR EQUIPMENT

### KITCHEN

FRIGDE	415€
MICROWAVE	174€
BUILT-IN INDUCTION HOB (TWO-ZONE)	313€
BUILT-IN EXTRACTOR	226€
DISHWASHER	510€

### BEDROOM

DOUBLE BED WITH MATTRESS 1.6x2m	969€
BUNK BED (INCLUDES MATTRESSES)	715€
FOLDABLE BUNK BED (INCLUDES MATTRESSES)	1 500€
WALL MOUNTED CABINET (120CM LONG)	300€
EXTRA CABINET (60CM LONG)	150€

MODEL YEAR 2022 PRICES.

We reserve the right to modify the specifications of our models without prior notice.  
PRICE NOT INCLUDING: VAT or taxes, shipping & handling, insurance, handover and launching



# WATERLILY BOATS

## AIR CONDITIONING AND HEATING

AIR CONDITIONING 12.000BTU SPLIT 2 126€

---

## DELIVERY

---

NAUTICAL GEAR (4 DOCK LINES,  
6 FENDERS, ANCHOR SET) 1 535€

ANTIFOULING 2 769€

TRANSPORT TBD

SHRINK WRAP IN POLYETHYLENE TBD

### GET IN TOUCH

Zona Industrial de Vagos, lote 90 | 3840-385 Vagos, PORTUGAL  
+351 234 036 585 | [geralew@boats.pt](mailto:geralew@boats.pt)  
**IG** @waterlilyboats **FB** Waterlily Boats  
[www.waterlilyboats.com](http://www.waterlilyboats.com)

### SUBSCRIBE OUR NEWSLETTER

[mailchi.mp/e1b24c36b517/subscription-waterlilyboats](mailto:mailchi.mp/e1b24c36b517/subscription-waterlilyboats)

